



ELECTRONICS



# 1/4" Hi-Impact Anti Vandal Dome Camera



## SCC-931TP

- x120 (x12 Optical Zoom, x10 Digital Zoom)
- 1/4" 470,000 pixels

# SCC-931TP

## 1/4" Hi-Impact Anti Vandal Dome Camera

- Clear screen quality with over : 480 lines of horizontal resolution
- Minimum illumination : 1 Lux(30IRE, Sense up Off) : 0.01 Lux (30IRE Sense up x128)
- Camera ID : Maximum 12 characters (Capable of a location setting)
- Backlight Correction Function
- White Balance Function
- Motion Detection Function
- Remote Control : RS-485 (Half Duplex)



### Specifications

Scanning System	625lines, 25frame/sec
Image Size	1/4inch 470,000 pixels
Effective Picture Elements	752(H) X 582(V)
Synchronizing System	Internal/Line Lock
Interlace	2 : 1 Interlace
Resolution	480 TV Lines
Video Output Level	VBS 1.0Vp-p, 75ohms, BNC
S/N	52dB
Min. Scene Illumination	1 Lux (30IRE) / 0.01 Lux (30IRE, Sense up x128)
Electronic Shutter	Off ~ 1/10,000 sec
Back Light Compensation	Off/On (Area/Position setting)
Sense Up	Max. x128 (Auto/Fix/Off)
Motion Detection	On/Off
Focus	AF/One AF/Manual
Viewing Angle	Wide : 52°E.8'(H) x 40°E.3'(V) Tele : 4°E.7'(H) x 3°E.6'(V)
Lens	Focal length : 3.6 ~ 43.2mm x120 (x12 Optical Zoom, x10 Digital Zoom)
Environmental Conditions	Operating Temperature : -10 ~ 50°C(14 ~ 122°F) / Humidity : Within 90% RH
Power Requirement	AC24V/DC12V, 50Hz
Power Consumption	Approx. 6W
Weight	Approx. 1kg
Dimensions (ø x H)	132(ø) x 95.3mm

### Dimensions(unit : mm)

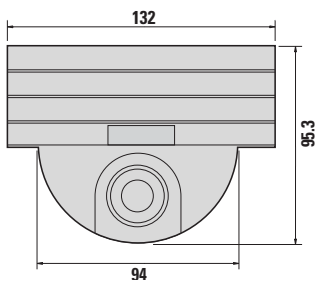

### Rear Panel



\* Design and specifications are subject to change without notice.



**Samsung Electronics Co., Ltd.**

**Digital Video Division**

416, Maetan-3Dong, Yeongtong-Gu, Suwon City, Gyeonggi-Do, Korea 442-742  
TEL : +82-31-200-9006 FAX : +82-31-200-5594  
<http://www.samsung.com/products/cctv.htm>